

		REVISIONS		
ZONE	REV.	DESCRIPTION	DATE	APPROVED
	1	notation updated	3/31/22	VP

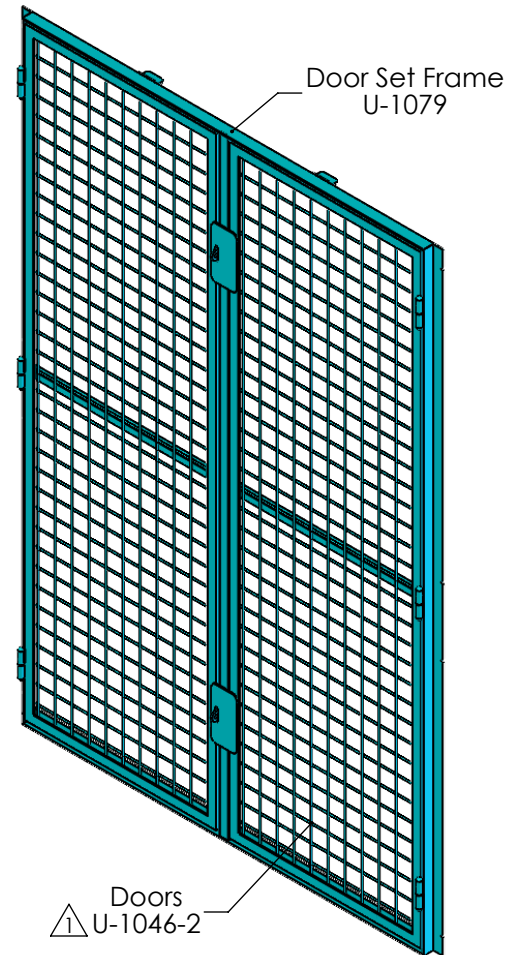
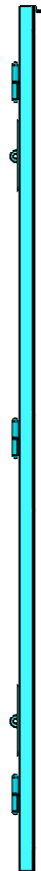
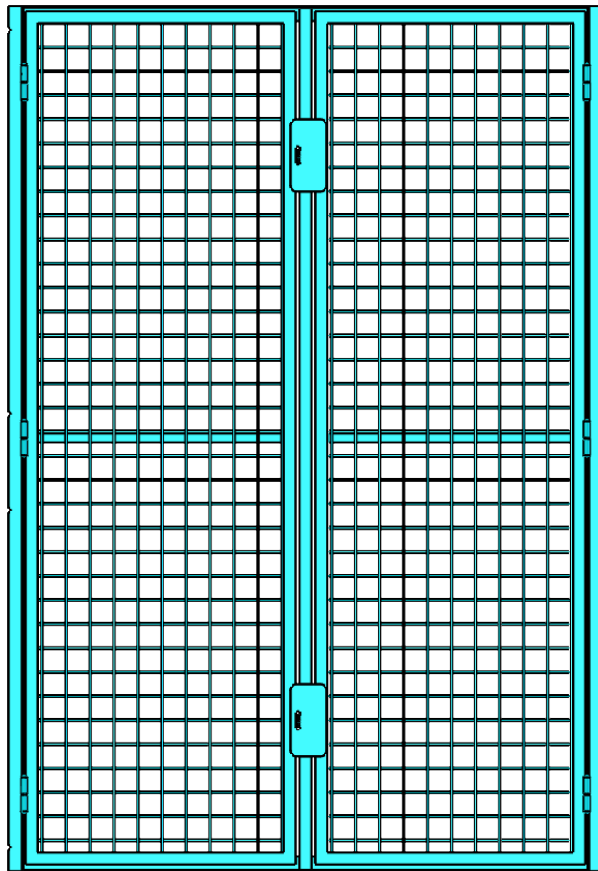

Fastener list for Framed Lock Up Door Sets

BOLT CARRIAGE 5/16" X 1-3/4" - PLTD. FB169
 WASHER LOCK 5/16" - PLTD. FW103
 NUT HEX 5/16" NC - PLTD. FN105

6' Door Set
 7' Door Set
 8' Door Set
 10' Door Set

6 of each
 6 of each
 8 of each
 8 of each

PROPRIETARY AND CONFIDENTIAL
 THE INFORMATION CONTAINED IN THIS DRAWING IS THE SOLE PROPERTY OF Unitran Manufacturers Ltd. ANY REPRODUCTION IN PART OR AS A WHOLE WITHOUT THE WRITTEN PERMISSION OF Unitran Manufacturers Ltd. IS PROHIBITED.

DIMENSIONS ARE IN INCHES
 TOLERANCES:
 FRACTIONAL ± 1/32"
 ANGULAR: MACH ± .5 BEND ± .5
 TWO PLACE DECIMAL ± .010
 THREE PLACE DECIMAL ± .005
 UNLESS OTHERWISE STATED

MATERIAL

 DO NOT SCALE DRAWING

	NAME	DATE
DRAWN	Dean S.	6/7/12
CHECKED	VP	10/3/17
ENG APPR.		
MFG APPR.	VP	10/3/17

COMMENTS:

Unitran Manufacturers

**Door Set Overview
 Framed Lock Up**

PART NO.	DWG. NO. U-1080	REV. 1
SCALE:	WEIGHT:	SHEET 1 OF 1